

BERKELEY® B4TPKHS

Cast Iron Impeller

Threaded Case (NPT), Mechanical Seal Construction

ELECTRIC MOTOR DRIVE SELF PRIME

| | |
|---------------------|---------------|
| Section | CC/SP |
| Page | 40.1 |
| Date | March 4, 2013 |
| Supersedes 01/01/04 | |

Table I

| B/M No. | HP | PH | RPM | Imp. No. |
|---------|----|----|------|----------|
| B54631 | 5 | 1 | 1800 | M05524 |
| B54632 | 5 | 3 | 1800 | M05524 |

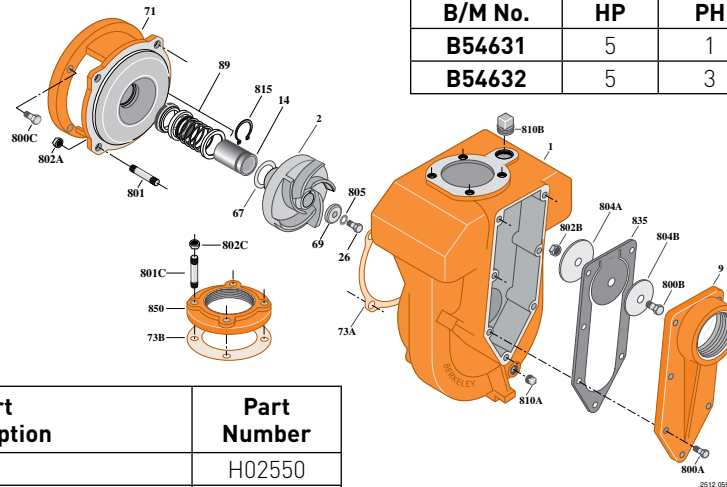

| Item No. | Part Description | Part Number |
|----------|---|--------------|
| 1 | Case, Volute | H02550 |
| 2 | Impeller | See Table I |
| 9 | Cover, Suction | L04108 |
| 14 | Sleeve, Shaft | S19310L |
| 26 | Screw, Impeller | S23568 |
| 32 | Key, 3/16 x 1-1/4" | S34383 |
| 67 | Spacer, Impeller | S15405 |
| 69 | Washer, Impeller Lock | S06314 |
| 71 | Bracket | See Table II |
| 73A | Gasket, Volute | S04757 |
| 73B | Gasket, Blind | S10364 |
| 89 | Seal, Mechanical Shaft | S32014 |
| 800A | Capscrew, 3/8 - 16 x 1-1/4" [7 Req.] | S26828 |
| 800B | Capscrew, 3/8 - 16 x 3/4" | S26824 |
| 800C | Capscrew, 3/8 - 16 x 1" 4-1/2 AK [4 Req.] | S26826 |
| 800C | Capscrew, 1/2 - 13 x 1" 8-1/2 AK [4 Req.] | S26912 |
| 801A | Stud, 1/2 - 13 x 1-1/2" [4 Req.] | S24043 |
| 801B | Stud, 5/8 - 11 x 2-1/2" [4 Req.] | S24062 |
| 802A | Nut, Hex 1/2 - 13 [4 Req.] | S23107 |
| 802B | Nut, Hex 3/8 - 16 | S23103 |
| 802C | Nut, Hex 5/8 - 11 [4 Req.] | S23109 |
| 804A | Weight, Clack | S14842 |
| 804B | Weight, Clack | S15325 |
| 805 | Washer, Lock | S23036 |
| 810A | Plug, Pipe 1/2 NPT | S23717 |
| 810B | Plug, Pipe 1-1/4 NPT | S23694 |
| 815 | Ring, Retaining | S11207 |
| 835 | Clack, Rubber | L04119 |
| 850 | Flange, Companion | S15933 |

Table II

| HP | PH | Bracket No. | "AK" Fit | "U" Dim. | Motor Frame |
|----|----|-------------|----------|----------|-------------|
| 3 | 1 | L05328 | 8-1/2" | 7/8" | 213JM |
| 3 | 3 | L05329 | 4-1/2" | 7/8" | 184JM |

NOTE: For an explanation of the tabulated material found on this page and for impeller key location, refer to **Supplement A** located at the beginning of section **CC**.